

# Installation guide for:



Arctic Foot  
L10



Claw Feet  
L1B  
L1W  
L1C



Arc Feet  
L2B  
L2W  
L2C



Classic Feet  
L3B  
L3W  
L3C

## Tools required:

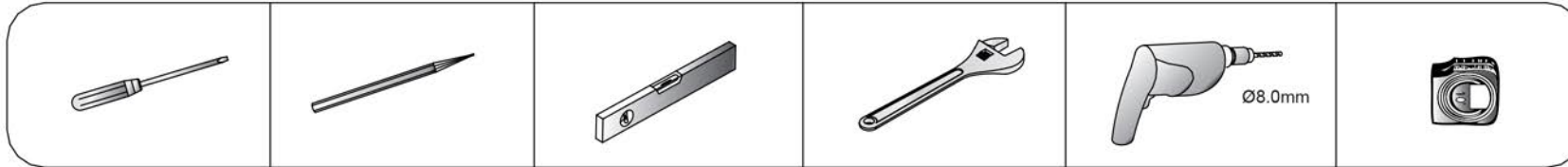

## Parts supplied:

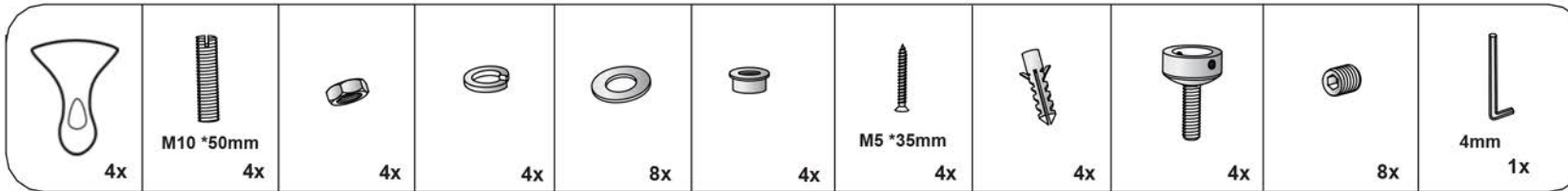

- Prior to installation check that all parts have been supplied.
- Assemble bath on a mat to protect against damage to bath surface.
- Bath diagram shown below is for reference only and bath legs fit to all baths.
- This product requires a two person lift - use proper lifting techniques.
- This installation guide does not include details of waste connection; final decision about installation of waste connection should be taken by a suitably qualified person.
- Follow each step in turn.

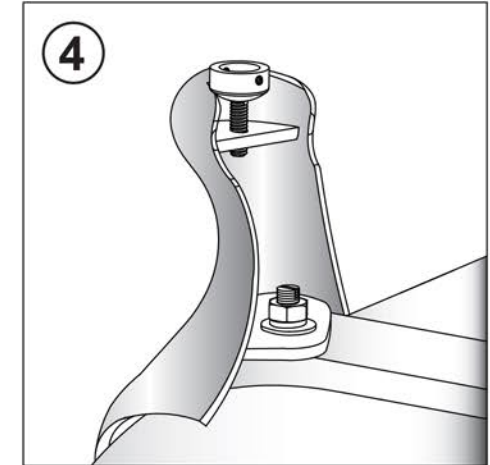
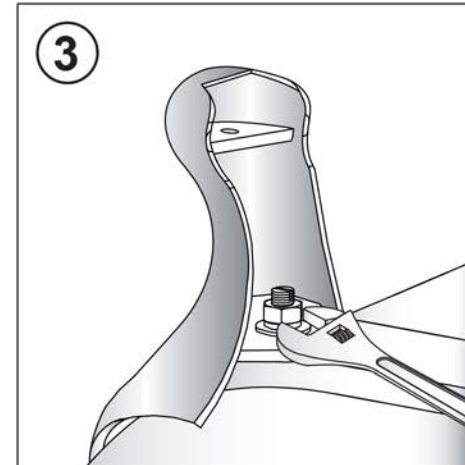
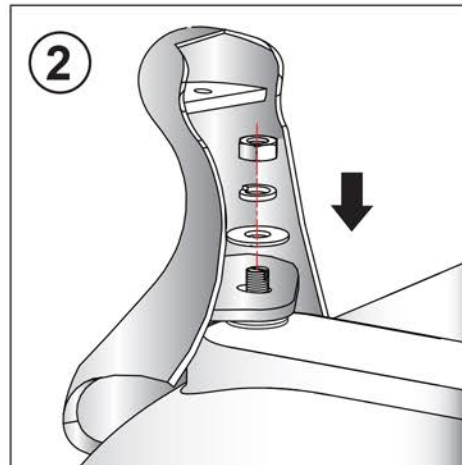
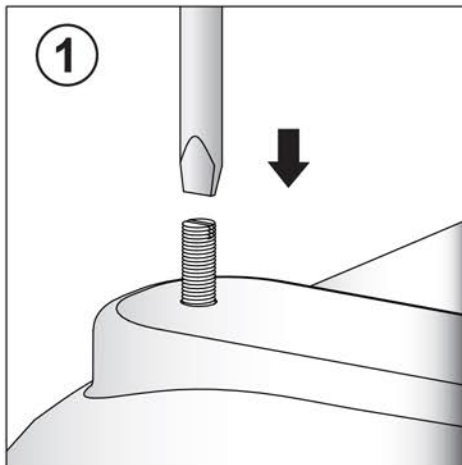

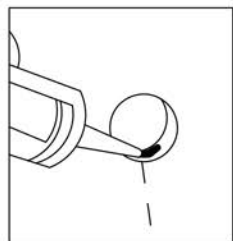
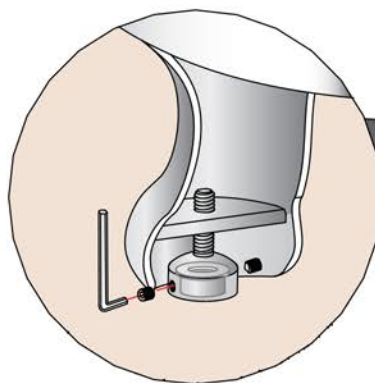
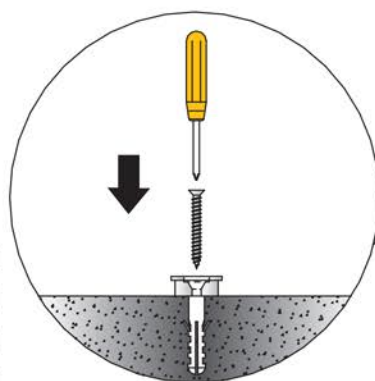
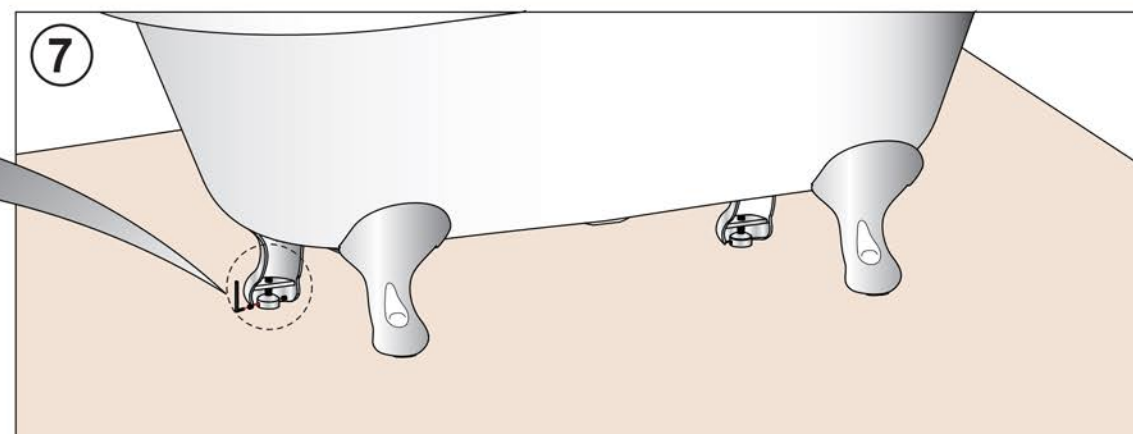
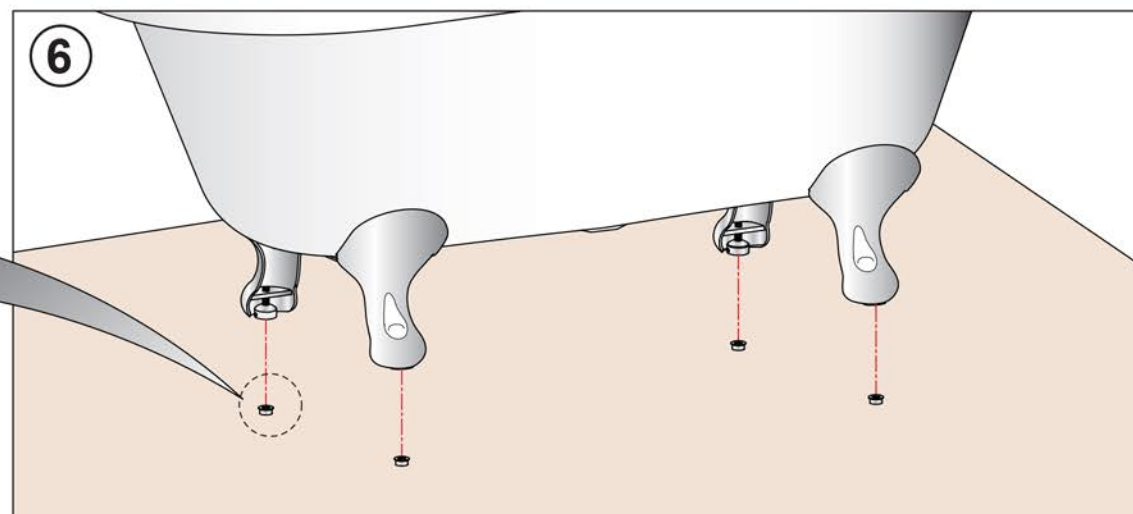
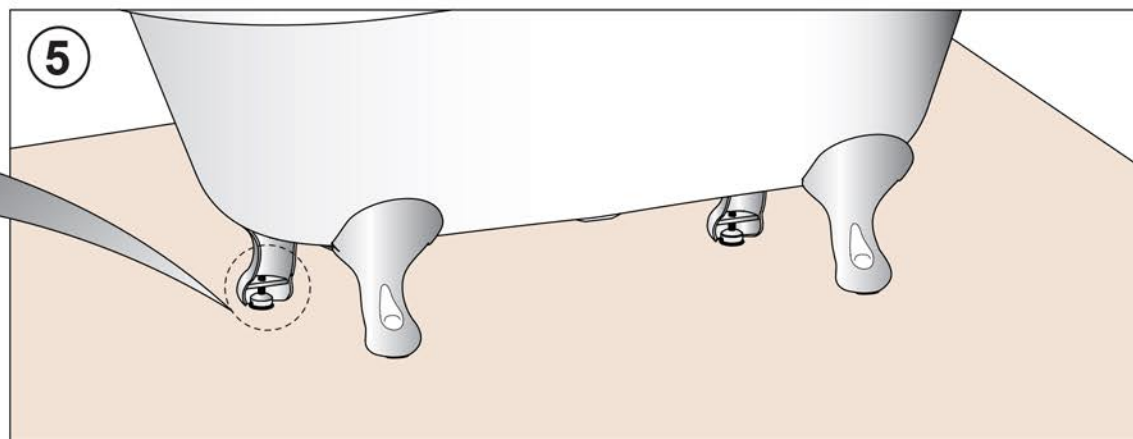
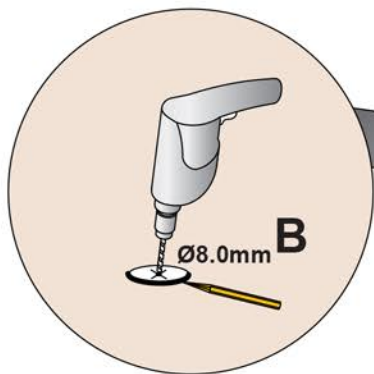
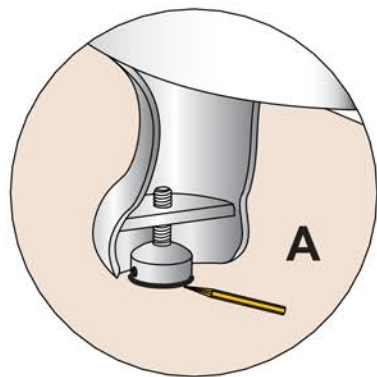

Once the bath is in the general position ready to be plumbed in, we suggest fitting the waste and overflow to the bath. Before you do this we insist you smear silicone sealant around the inside of the overflow and waste to ensure a totally water tight seal. This is shown in the diagram above.